

Connect to original DVDS power cable

Reserved cable to connect to the plug under control knob. Only connect it when moving carplay menus, and original menu moving simultaneously

CIC-KT2, not necessary to connect. Only connect it when moving carplay menus, and original menu moving simultaneously

CIC-KT, connected in default, get knob signal from head unit.

CIC module

Connect to original DVD'S LVDS input

connect to car aux input

connect to original DVD'S input

Reserved Mic input

Extend LVDS cable

Connect to original DVD'S LVDS cable, original screen not need removed

Reserved rear view camera

MIC cable. Only necessary to connect when original MIC can not work

WIFI antenna, paste to where is plastic. Don't paste it to the box or metal.

USB

External MIC



DIP Switch Setting

Screen system	Car model	Screen size	DIP switch setting	
NBT	1 series-7 series (2013-2017)	6.5inch	1, 2 set to ON; 3, 4, 5, 6,7, 8 set to OFF	
	X1-X6 (2013-2017)			
	MINI (2013-2017)			
		M3-M5 (2013-2017)	8.8/ 10.2inch	1, 2, 3 set to ON; 4, 5, 6,7, 8 set to OFF
		Z4 (2013-2017)		
		Electrical 5 series (2015-2017)		
		i3/i8 (2013-2017)	8.8inch	
CIC	1 series-7 series (2008-2013)	6.5inch	4 set to ON; 1, 2, 3, 5, 6,7, 8 set to OFF	
	X1-X6 (2008-2013)			
	MINI (2008-2013)			
		M3-M5 (2008-2013)	8.8/ 10.2inch	3, 4 set to ON; 1, 2, 5, 6,7, 8 set to OFF
		Z4 (2008-2013)		



How to enter and exit the box system menu?

-Press button "MENU" on console for about 3 seconds to enter or exit the box system menu.



Steps to connect wireless CarPlay

- Power on the car and enter the box system menu
- Turn on WiFi on the phone
- Turn on Bluetooth on the phone and stay in the Bluetooth interface
- Turn on WirelessDev menu on screen
- Click menu connect mobile device, click start search, choose your iPhone and iAP2 profile
- Click Pair on the phone, click Allow and User CarPlay on the phone.

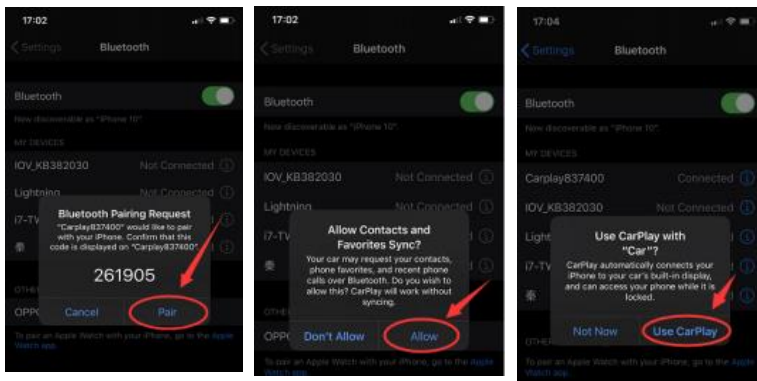
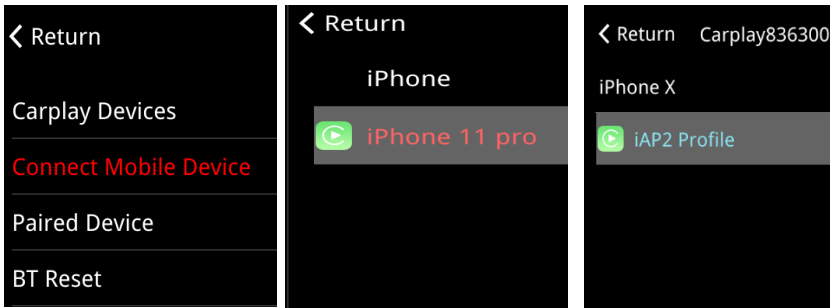
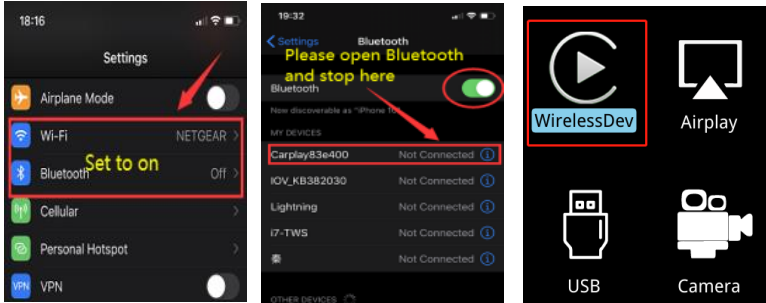

Steps to connect wireless Android Auto

- Power on the car and enter the box system menu
- Turn on WiFi on the phone
- Turn on Bluetooth on the phone and stay in the Bluetooth interface
- Turn on WirelessDev menu on screen
- Click menu connect mobile device, click start search, choose your phone, click either "Hands Free Profile" or "Advanced Audio Distribution Profile"
- Click pair on the phone, click OK to use.

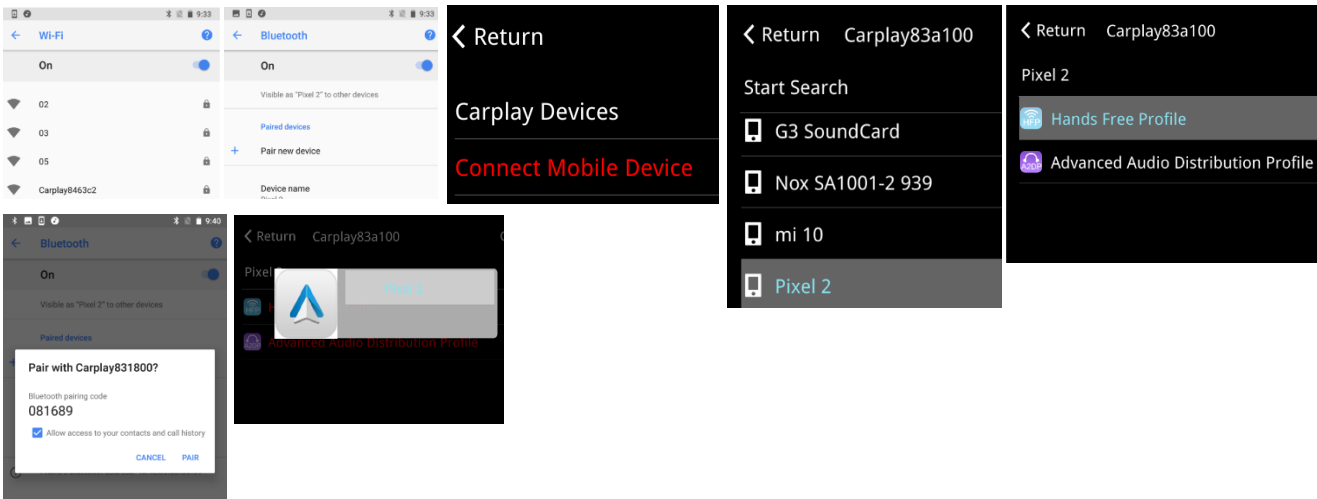

How to get sound in CarPlay or Android Auto?

- If there is optical cable (normally two yellow cable) in original radio power plug, move it to corresponding position in new power plug.

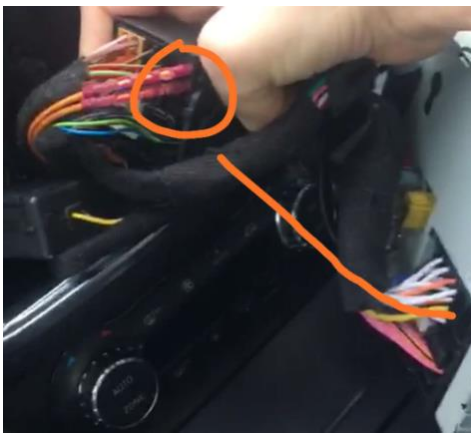

- Go to original system Audio menu to select AUX as audio source first, it will have sound after that.



- If still no sound, plug the AUX cable in new power cable to car AUX input.



Camera setting

Rear camera

If your car is with original factory rear camera, go to menu Setup>Reverse>Reverse Camera, set reverse camera to Original. If camera is aftermarket, set it to Aftermarket.

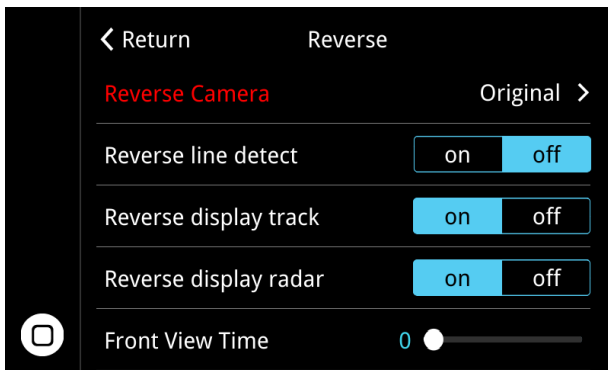

Front camera

If you connect one front camera, you can click the Camera menu to check front camera image or you can set front view time to check front camera image.

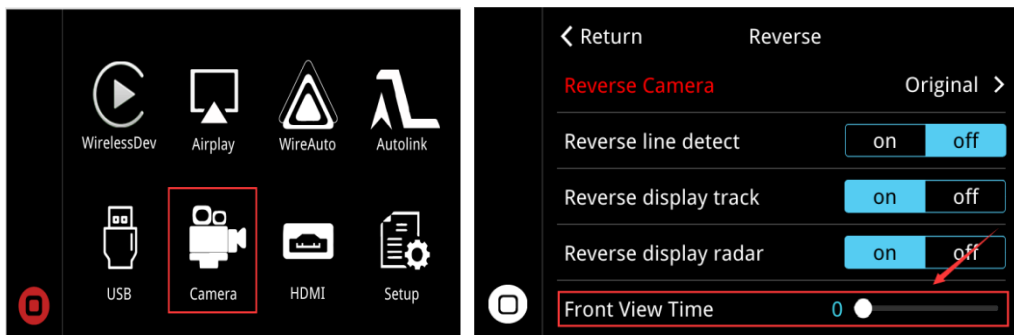

How to update firmware?

System update steps

- Copy the file "ISPBOOOT.BIN" to root directory of USB flash sticker
- Connect the USB flash sticker to USB cable of the box
- Enter the box system menu, click Setup menu
- Click software update, input code 2863 to enter
- Click system update, it pops to ask whether to update, click "√" to update
- Wait about 3 minutes for the update to finish, do not power off during update
- When update complete, the screen will return to original menu

MCU update steps

- Copy the file "Upgrade.BIN" to root directory of USB flash sticker
- Connect the USB flash sticker to USB cable of the box
- Enter the box system menu, click Setup menu
- Click software update, input code 2863 to enter
- Click MCU update, it pops to ask whether to update, click "√" to update
- Wait about 1 minutes for the update to finish, do not power off during update
- When update complete, the screen will return to original menu